

How To Use Mobile Phone APP

1. Search for "ThinkDiag+" in GooglePlay or "ThinkDiag" in App store and download it.

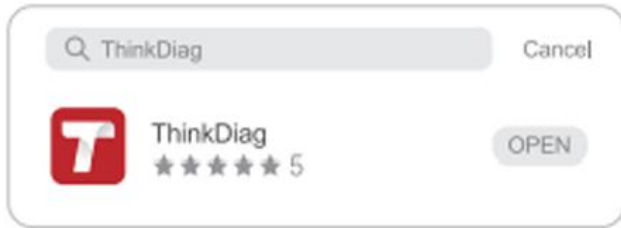

(iOS)

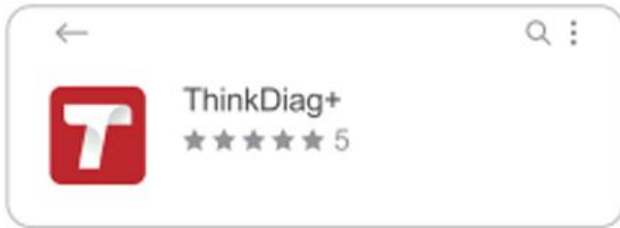

(Android)

2. Register account with Email.

A screenshot of the "Login" screen. It features a red header with the word "Login" and a close button. Below the header are two input fields: "Your email address" and "Password". At the bottom, there are links for "Sign Up" and "Forgot Password", and a large red "Login" button.A screenshot of the "Sign Up" screen. It features a red header with the words "Sign Up" and a close button. Below the header are two input fields: "Enter 2-20 letters user name" and "Please enter your password". At the bottom, there is a link for "Have an Account?" and a large red "Next" button.

3. Go to the homepage and select



4. Select the THINKTPMS module

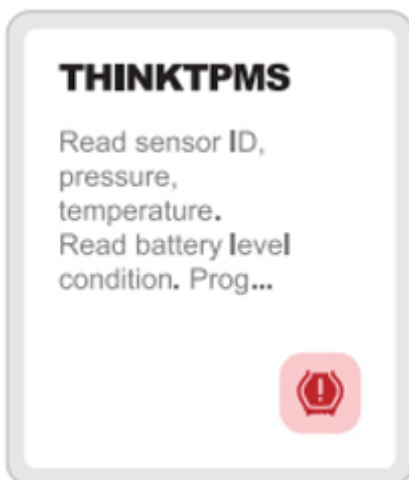

5. Enter the Serial Number and Activation Code to activate the device.

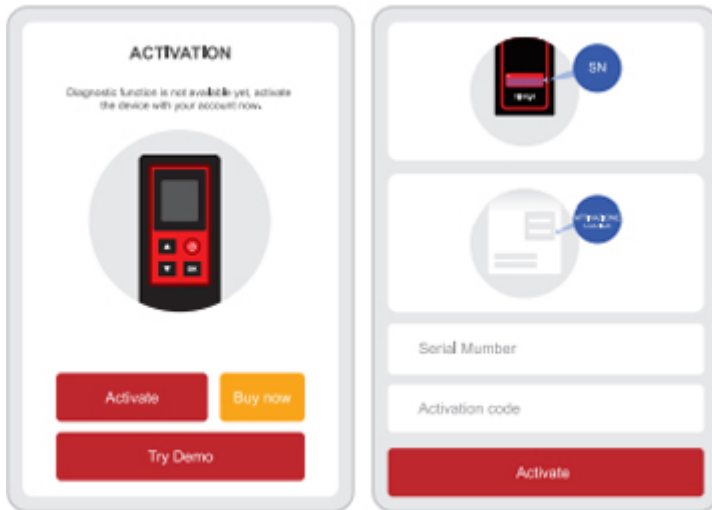

6. After the binding is successful, the program will be updated automatically.

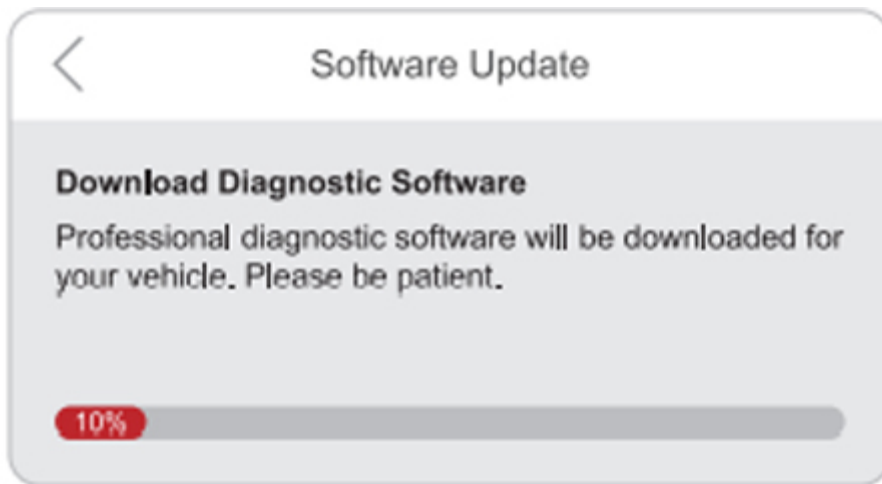

7. Select brand, model, year, frequency band of the tire pressure sensor.



8. Using THINKTPMS G2, it supports activating the tire pressure sensor, reading the version number, and reading the tire pressure value. For online programming function and tire pressure learning function, please purchase THINKDIAG connector or other THINKCAR diagnostic equipment.

